

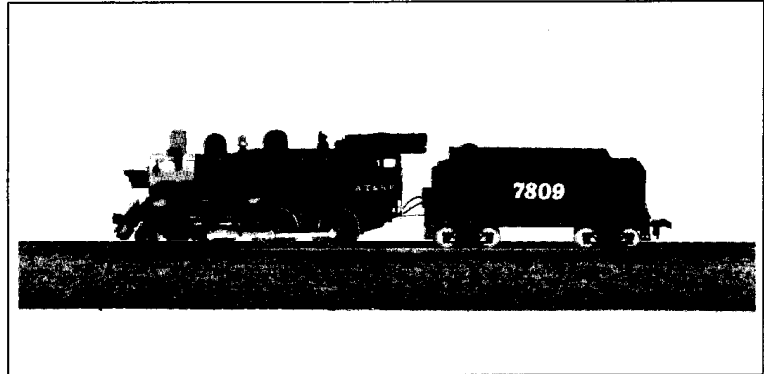

INTERNATIONAL HOBBY CORPORATION
413 E. Allegheny Ave
PHILADELPHIA, PA 19134
Pennsylvania, USA

STEAM LOCO 2-6-0 MOGUL



The 2-6-0 Mogul was a fast freight locomotive of the late 1800s, designed as a successor to the 4-4-0 American locomotives. The Mogul's larger drivers gave them greater speed than the slower heavier 2-8-0 Consolidations, and their ability to outperform the 4-4-0 in both power & speed on runs with frequent stops & fast schedules made them a much accepted workhorse. Some were earmarked for passenger service because of their speed & reliability. Though many Moguls had disappeared from service on Class I railroads by 1930, some continued to serve well on smaller railroads well into the 1940s. A handful of restored Moguls are working even today on preserved scenic railroads.

IHC POWERED EQUIPMENT AND COMPONENTS COME WITH A 90 DAY LIMITED WARRANTY.

IHC will remedy any defect or malfunction occurring in any component within 90 days from date of purchase. This warranty does not extend to defects or malfunctions which are caused by damage (not resulting from the defect or malfunction) while the product is in the possession of any consumer, or by unreasonable use (including failure to provide proper lubrication) while the product is in the possession of any consumer.

This warranty is given in lieu of all expressed warranties, including but not limited to implied warranties. All implied warranties of fitness and merchantability, shall expire ninety (90) days from the date of purchase. Some states do not allow limitations on how long an implied warranty lasts, so the above limitation may not apply to you.

Under no circumstances shall IHC be responsible for any incidental or consequential damages arising in regard to any IHC product. Some states do not allow the exclusion or limitation of incidental or consequential damages, so the above limitation may not apply to you.

In order to validate this warranty, the Owner Registration Card enclosed must be completed and mailed within ten (10) days after purchase of product: to IHC
PHILADELPHIA, PA 19134 USA.

If warranty service is required within ninety (90) days from the date of purchase, please send the component requiring service, postage prepaid, to IHC, Philadelphia, PA 19134. If warranty service is required after more than ninety days from date of purchase, please send the component requiring service, postage prepaid, with a check or money order for USD 5.00 to cover postage and handling to IHC, Philadelphia, PA 19134. In either case please write a letter explaining the nature of your difficulty and enclose it with the component.

At the option of IHC, the component will either be repaired or replaced, except that if either repair or replacement are not practicable, then a refund of the purchase price will be made. This warranty gives you specific legal rights and you may also have other rights which vary from state to state.

In the event you have questions concerning use and care of your purchase or any complaints concerning services, please write:

INTERNATIONAL HOBBY CORPORATION,
PHILADELPHIA, PA 19134

NOTE: BREAKAGE FROM DROPPING OR MISUSE IS NOT COVERED BY THIS WARRANTY.

2 - 6 - 0 MOGUL PARTS LIST

1. Cab	P522-001 (ATSF) P522-002 (PRR) P522-003 (SP) P522-004 (SRR) P522-093 (CV) P522-005 (B&O) P522-006 (CN) P522-004 (GB&W) P522-007 (NYC) P522-008 (CG) P522-095 (NH) P522-009 (TP) P522-010 (IC) P522-106 (CN) P522-107 (UNDEC) P522-108 (B&M) P522-109 (NYO&W) P522-011 (ATSF SP) P522-012 (PRR, NYC) P522-013 (SRR) P522-086 (CV) P522-014 (B&O) P522-015 (CNW, B&M, NYO&W) P522-097 (GB&W) P522-016 (CG) P522-098 (NH, CN, UNDEC) P522-017 (TP) P522-018 (IC) P522-019 (ATSEPRR, SPCV/B&O, CNW, GB&W, NYC, NH, TP, IC, UNDEC, B&M, NYO&W)
2. Boiler	P522-020 (SRR) P522-021 (CG) P522-103 (CN)
3. Under Boiler Body	P522-022 P522-023 P522-024 P522-025 P522-026 P522-027 (Black) P522-028 (SRR Green) P522-027 (Black) P522-026 (SRR Green) P522-027 (Black) P522-028 (SRR Green) P522-029 (Black) P522-030 (SRR Green) P522-027 (Black) P522-028 (SRR Green) P522-032 P522-027 (Black) P522-028 (SRR Green) P521-018 P522-033 P522-034 (Black) P522-035 (SRR Green) P522-036 (Silver) P522-037 (Grey) P522-038 (Black) P522-099 (Graphite)
4. Main Frame Upper Cover-Complete with Pick-ups Riveted together w/wires	P522-022
5. Main Frame	P522-023
6. Main Frame Under Cover	P522-024
7. Handrail Rear - Right Side	P522-025
8. Handrail Rear - Left Side	P522-026
9. Valve	P522-027 (Black) P522-028 (SRR Green) P522-027 (Black) P522-026 (SRR Green) P522-027 (Black) P522-028 (SRR Green) P522-029 (Black) P522-030 (SRR Green) P522-027 (Black) P522-028 (SRR Green) P522-032 P522-027 (Black) P522-028 (SRR Green) P521-018 P522-033 P522-034 (Black) P522-035 (SRR Green) P522-036 (Silver) P522-037 (Grey) P522-038 (Black) P522-099 (Graphite)
10. Valve Base	P522-027 (Black) P522-026 (SRR Green)
11. Generator	P522-027 (Black) P522-028 (SRR Green)
12. Pipe - Left	P522-029 (Black) P522-030 (SRR Green)
13. Bell	P521-001
14. Name Plate - Left	P522-027 (Black) P522-028 (SRR Green)
15. Pipe - Right	P522-029 (Black) P522-030 (SRR Green)
16. Name Plate - Right	P522-027 (Black) P522-028 (SRR Green)
17. Long Handrail	P522-032
18. Light - Left & Right	P522-027 (Black) P522-028 (SRR Green)
19. Handrail Post	P521-018
20. Handrail Post - Long	P522-033
21. Head Light	P522-034 (Black) P522-035 (SRR Green)
22. Smokebox Cover	P522-036 (Silver) P522-037 (Grey) P522-038 (Black) P522-099 (Graphite)
23. Light Bulb w/wires	P521-004
24. Handrail - Right	P522-039
25. Handrail - Left	P522-040
26. Weight - Front	P522-041
27. Weight - Center	P522-042
28. Weight Holder	P410-025
29. Spacer	P522-043
30. Cylinder Cover	P522-044
31. Guides	P522-045
32. Cylinder	P522-046 (Black) P522-047 (SRR Green)
33. Screw	P521-002
34. Weight - Rear	P522-048
35. Motor Holder	P522-049
36. Motor	P522-050
37. Worm Gear	P521-020
38. Idler Gear	P410-006
39. Idler Gear Shaft	P522-051
40. Shaft Holder	P522-052
41. Oil Pump	P522-029 (Black) P522-030 (SRR Green)
42. Steam Cylinder Pipe	P522-053
43. Right Slider with Main Rod	P522-054
44. Left Slider with Main Rod	P522-055
45. Valve Gear Hanger	P522-056
46. Weight - Cab	P522-057
47. Drawbar	P522-058
51. Steam Pipe	P522-029 (Black) P522-030 (SRR Green)
52. Stair	P522-027 (Black) P522-028 (SRR Green)
53. Coupler Lift Bar	P522-059
54. Dummy Coupler	P521-011
55. Pilot	P522-090
61. Front and Rear Drivers	P522-061
62. Spring Plate	P522-062
64. Mount Screw	P522-063
65. Pilot Truck	P522-064
67. Pilot Truck Wheel	P522-065
69. Pilot Truck Mounting Screw	P522-066
70. Washer	P522-067
71. Gears Drivers	P522-068
75. Connecting Rod	P522-069
76. Crank Pin Screw	P522-070
78. Underframe Cover Screw	P522-071
80. Fill Pipe Cover	P522-072 (Black) P522-073 (Red) P522-074 (Oxide) P522-075 (Black) P522-076 (Red) P522-077 (Oxide) P522-078 (ATSF) P522-079 (PRR) P522-080 (SP) P522-081 (SRR) P522-100 (CV) P522-082 (B&O) P522-083 (CNW) P522-101 (GB&W) P522-084 (NYC) P522-085 (CG) P522-102 (NH) P522-086 (TP) P522-087 (IC) P522-104 (CN) P522-105 (UNDEC) P522-110 (B&M) P522-111 (NYO&W)
81. Tender Top Cover	P522-072 (Black) P522-073 (Red) P522-074 (Oxide) P522-075 (Black) P522-076 (Red) P522-077 (Oxide) P522-078 (ATSF) P522-079 (PRR) P522-080 (SP) P522-081 (SRR) P522-100 (CV) P522-082 (B&O) P522-083 (CNW) P522-101 (GB&W) P522-084 (NYC) P522-085 (CG) P522-102 (NH) P522-086 (TP) P522-087 (IC) P522-104 (CN) P522-105 (UNDEC) P522-110 (B&M) P522-111 (NYO&W)
82. Tender Body	P522-072 (Black) P522-073 (Red) P522-074 (Oxide) P522-075 (Black) P522-076 (Red) P522-077 (Oxide) P522-078 (ATSF) P522-079 (PRR) P522-080 (SP) P522-081 (SRR) P522-100 (CV) P522-082 (B&O) P522-083 (CNW) P522-101 (GB&W) P522-084 (NYC) P522-085 (CG) P522-102 (NH) P522-086 (TP) P522-087 (IC) P522-104 (CN) P522-105 (UNDEC) P522-110 (B&M) P522-111 (NYO&W)
83. Underframe	P522-088
84. Weight	P522-089
87. Rear Truck Frame	P522-090
88. Coupler	P521-023
89. Front Truck Frame	P522-091
90. Nut	P410-058
91. Truck Frame Mount Screw	P410-070
92. Contact	P410-059
93. Pick - ups	P410-063
94. Tender Wheel	P522-092

M510 MOGUL, ATSF
M511 MOGUL, PRR
M512 MOGUL, SP
M513 MOGUL, SRR (SOUTHERN)
M514 MOGUL, CV
M515 MOGUL, B&O
M516 MOGUL, C&NW
M517 MOGUL, GB&W
M518 MOGUL, NYC

M519 MOGUL, CG (CENTRAL OF GEORGIA)
M520 MOGUL, NH
M521 MOGUL, TP (TEXAS PACIFIC)
M522 MOGUL, IC
M523 MOGUL, CN
M524 MOGUL, UNDEC
M526 MOGUL, B&M
M527 MOGUL, NYO&W

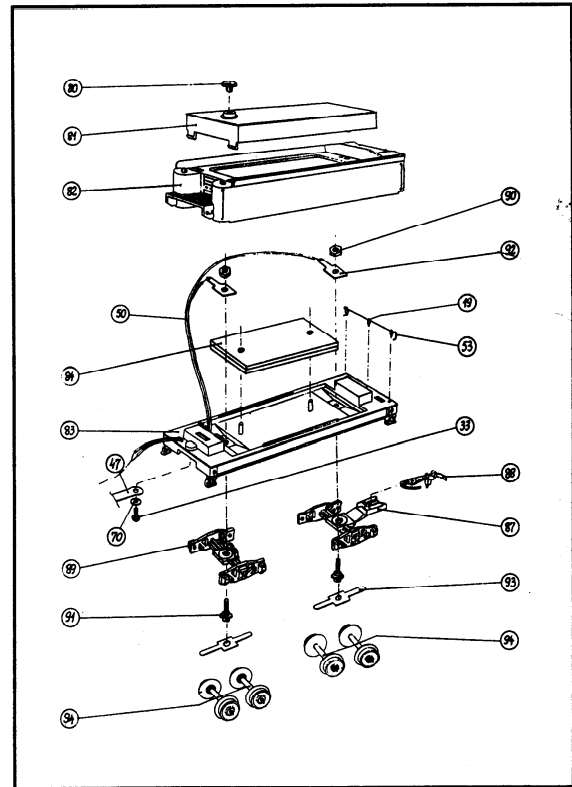
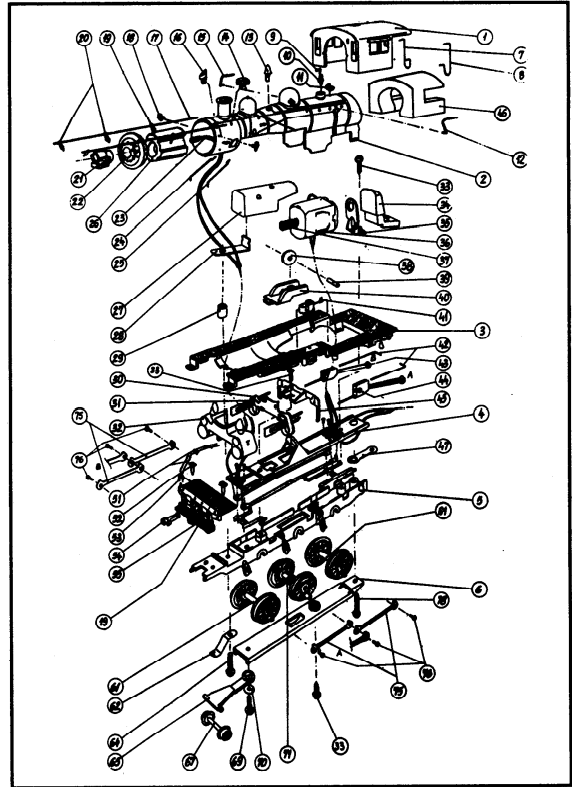

Parts diagram numbers: 9, 10, 11, 14, 16, 18 & 52 are on a single sprue and parts diagram numbers: 12, 15, 41 & 51 are on a different single sprue. These parts are not available separately; only the complete sprue on which they appear is available.

Printed in Slovenia

T002201AB/21466

LUBRICATION

For efficient economical operation, proper lubrication is important. To lubricate axles, gears and bearings, use screw No33, No69 and No78 in the Main Frame Under Cover No6. Lubricate with light clock oil only.

ELECTRICAL DATA

Maximum Draw : 0,25 Ampere
Maximum Voltage : 12 V DC